



SIXTY82™

The new original

USER MANUAL – STAGE82

- PART 2- SPECIFIC REQUIREMENTS

APRIL 2020 **Art Number:** xxxxxxxx

Manufacturer:

SIXTY82 B.V.

Amperelaan 9
9207AM Drachten
The Netherlands

Phone +31 (0)88 1342200
Email info@sixty82.nl

CONTENT

- 1. SAFETY INSTRUCTIONS**
- 2. SCOPE**
- 3. IDENTIFICATION**
- 4. LIMITATIONS OF USE**
- 5. TRANSPORT AND STORAGE**
- 6. APPROVED ACCESSORIES**
- 7. COATINGS AND SURFACE TREATMENTS**
- 8. ASSEMBLY & DISASSEMBLY INSTRUCTIONS**
- 9. INSPECTIONS**
- 10. MAINTENANCE AND DISCARD CRITERIA**
- 11. LEGISLATION**
- 12. GUARANTEE**
- 13. DISCLAIMER**

1. SAFETY INSTRUCTION

Before using SIXTY82 STAGE82 staging module read this manual carefully and pay attention to the information provided. Use this manual to familiarise yourself with the products, its proper use and safety regulations.

Explanation of symbols:



DANGER: Indicates a hazardous situation which, if not avoided, will result in death or serious injury. This signal word is to be limited to the most extreme situations.



WARNING: Indicates a hazardous situation which, if not avoided, could result in death or serious injury.



CAUTION: Indicates a hazardous situation which, if not avoided, could result in minor or moderate injury.



NOTICE: address practices not related to personal injury.



SAFETY INSTRUCTIONS: is used for a lists of steps, procedures or instructions that might otherwise substitute a DANGER, WARNING or CAUTION notification.



THIS MANUAL SHALL BE INSEPARABLY USED IN CONJUNCTION WITH ORIGINAL "USER MANUAL "TRUSS AND ASSOCIATED COMPONENTS - PART 1 - GENERAL REQUIRMENTS" AND VICE VERSA. THE PART 2 MANUALS CONTAINS PRODUCT SPECIFIC REQUIREMENTS REGARDING LEGISLATION, SET-UP, DISMANTLING, ALLOWABLE LOADING AND ANY OTHER INFORMATION NOT REFERRED TO IN PART 1. PART 2 IS ALWAYS SUPERSEDING PART 1.



MAKES URE MANUALS ARE AVAIALBLE AT ALL TIMES FOR ALL USERS AND EMPLOYEES



DO SOLELY USE GENUINE SIXTY82 COMPONENTS



DO NOT INCREASE ANY DIMENSIONS OF THE ASSEMBLED STRUCTURE



IF ANY DEFAULTS ARE FOUND, MARK THE COMPONENT CLEARLY AND TAKE OUT OF SERVICE



IN CASE OF DOUBT, CONTACT A COMPETENT PERSON OR THE MANUFACTURER



THE STAGING LEGS SHALL NOT BE USED TO BUILT GRANDSTANDS WITH A HEIGHT \geq 100CM. THE PLATFORMS CAN



THE STRUCTURE SHALL BE SAFEGUARDED FROM PUBLIC OR COLLISION FROM VEHICLE



STAGING MODULES SHALL BE ASSEMBLED BY A COMPETENT PERSON OR SUFFICIENTLY INSTRUCTED PERSONNEL UNDER SUPERVISION OF A COMPETENT PERSON



AS A SINGLE STAGE ELEMENT SHALL BE HANDLED BY 2 PERSONS. THIS DUE THE SELFWEIGHT AND THE EASE OF INSTALLING

2. SCOPE

The intended use of the staging module is to create a raised platform which can be repeatedly assembled and disassembled in order to carry loads in temporary or permanent installations.

The staging modules can be used, but not limited to, for artistic performances, to build a raised platform for public or to show case products

It is also possible to support other loads as long as they do not exceed the weight and dimensions given or if approved by a chartered engineer. When considering the allowable loading, dynamic effects caused by e.g. dancing, jumping people or moving objects must be considered by a chartered engineer or by consulting Sixty82. Any other use is considered mis-use and the sole responsibility of the user unless approved by Sixty82.

The load it self is not part of the design and this manual.

 It shall be noted that it is the sole responsibility of the user to check with local authorities if the legislation used by SIXTY82 is accepted in the country of use.

 Staging modules can be used to build grandstands up to a height of 100cm. When grandstands are build higher as 100cm, we refer to EN 13200 series of standards.

3. IDENTIFICATION

Assembled SIXTY82 staging modules or accessories can be recognised by the specific ID-tag on all Staging Modules, product stickes and/or embossed serial numbers.

Item	Art code	Description
1	900538	Main profile Stage82 M long side
2	902734	Main profile Stage82 M short side
3	901586	Middle beam
4	901589	Wood plate, black
5	861003	Leg pocket assembly
Item	Art code	Description
6	903299	Pocketclamp stage82 corner
7	903337	Pocketclamp stage82 clamp
8	861004	Stage82 pocket clamp handle
9	861005	Stage82 pocket clamp plate
10	816008	Eye bolt M10x40 DIN444b
11	816002	Nut self locking M10 DIN985
12	861007	Stage82 pocket clamp spring
13	861006	Stage82 pocket shaft 10x17
14	815002	Bolt Cup square neck M8x20 DIN 603
15	815006	Washer M8, DIN125A
16	815001	Nut self locking M8 DIN985

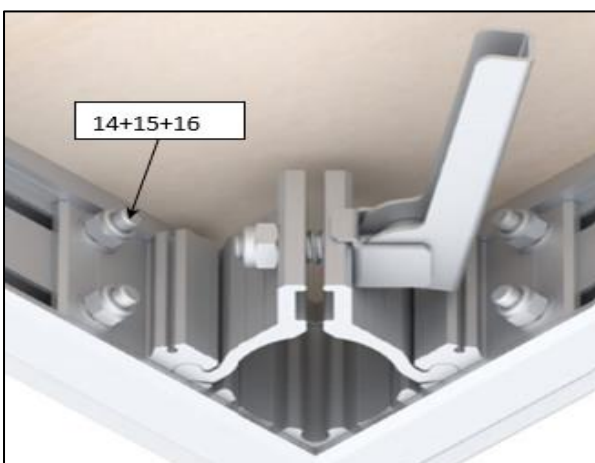
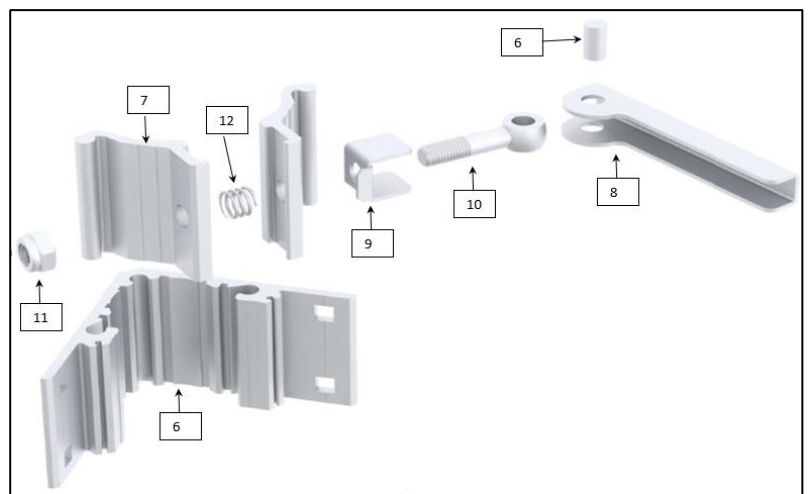
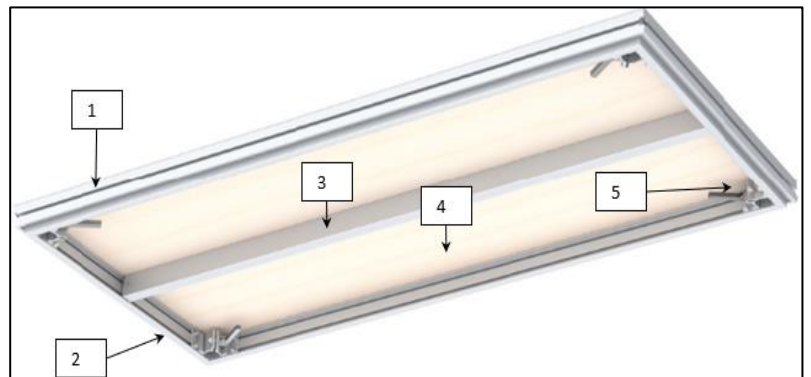

Item	Art code	Description	weight
1	310001	Stage82 module M 200x100cm hexa	35,68
2	310002	Stage82 module M 100x100cm hexa	21,70
3	310003	Stage82 module M 200x050cm hexa	24,50
4	310004	Stage82 module M 100x050cm hexa	14,00
5	310005	Stage82 module M 200x100cm triangle left hexa	26,00
6	310006	Stage82 module M 200x100cm triangle right hexa	26,00
7	310007	Stage82 module M 100x100cm triangle hexa	13,00
8	310015	Stage82 module M dia 200cm 90dgr hexa	22,00
9	310016	Stage82 module M dia 400cm 45dgr hexa	26,00
10	310017	Stage82 module M dia 600cm 22,5dgr hexa	26,00
11	311001	Stage82 module M 200x100cm black	35,68
12	311002	Stage82 module M 100x100cm black	20,80
13	311003	Stage82 module M 200x050cm black	21,17
14	311004	Stage82 module M 100x050cm black	14,00
15	311005	Stage82 module M 200x100cm triangle L black	26,00
16	311006	Stage82 module M 200x100cm triangle R black	26,00
17	311007	Stage82 module M 100x100cm triangle black	13,00
18	311029	Stage82 module M dia 200cm 90dgr black	22,00
19	311030	Stage82 module M dia 400cm 45dgr black	26,00
20	311031	Stage82 module M dia 600cm 22,5dgr black	26,00
		Accessories	
21	360002	Kickboard length 85cm click on	0,76
22	360003	Kickboard length 185cm click on	2,81
23	360004	Stage to stage connector	0,05
24	360005	Stage to stage leveler	0,07
25	360009	Skirting profile length 085cm	0,56
26	360010	Skirting profile length 100cm	0,58
27	360011	Skirting profile length 185cm	1,14
28	360012	Skirting profile length 200cm	1,14
29	360034	Stage to stage clamp	0,52
30	360035	Leg to Leg ETP Clamp 2-way	0,61
31	360039	Kickboard length 100cm click on	1,17
32	360040	Kickboard length 200cm click on	2,34
		Legs	
33	340001	Leg stage height 020cm	0,23
34	340002	Leg stage height 040cm	0,46
35	340003	Leg stage height 060cm	0,69
36	340004	Leg stage height 080cm	0,93
37	340005	Leg stage height 100cm	1,16
38	340006	Leg stage height 120cm	1,28
39	340007	Leg stage height 020cm adjustable feet	0,27
40	340008	Leg stage height 040cm adjustable feet	0,49
41	340009	Leg stage height 060cm adjustable feet	0,72
42	340010	Leg stage height 080cm adjustable feet	0,95
43	340011	Leg stage height 100cm adjustable feet	1,18
44	340012	Leg stage height 120cm adjustable feet	1,41
45	340013	Leg stage height 45/60cm telescopic	1,89
46	340014	Leg stage height 60/90cm telescopic	2,51
47	340015	Leg stage height 90/140cm telescopic	3,57
48	340016	Leg stage height 100/160cm telescopic	4,22
49	340017	Leg stage height 120/190cm telescopic	5,10
		Railing	
50	350005	Stage railing 1m Module M 30kg-m	7,34
51	350006	Stage railing 2m Module M 30kg-m	11,46
52	350007	Stage railing spigot Module M 30kg-m	0,60

4. LIMITATION OF USE

- Staging Modules must be used within the limits of the structural report.
- Loading figures mentioned are only valid for static loads.
- Self-weight is already taken into account.

LOADING 4.1 MAXIMUM UNIFORMLY DISTRIBUTED LOAD



Check alloy when legs are not purchased at Sixty82

podium height/ Podesthöhe	80 cm (40/ 60 cm)	100 cm	120 cm	140 cm	160 cm
column/Stützen					
tube/Rundrohr 48,3x3mm EN AW 6082 T6	750 kg/m ²	500 kg/m ²	500 kg/m ²	350 kg/m ²	350 kg/m ²
tube/Rundrohre 48,3x3mm EN AW 6060 T6	500 kg/m ²	500 kg/m ²	350 kg/m ²	not allowed/ nicht zulässig	not allowed/ nicht zulässig
tube/Rundrohre 48,3x3,25mm S235JR	750 kg/m ²	750 kg/m ²	500 kg/m ²	500 kg/m ²	500 kg/m ²

LOADING 4.2 MAXIMUM POINT LOAD

LC1 = 2x 150kg at a distance of minimum 500mm at any place

LC2 = 350kg single point load above each of the 200cm sides or middle beam

LC3 = 500kg in the middle of the 100cm sides.

LC4 = 210kg in the middle of an unsupported woodplate



Point loads need to have a 50x50mm bearing surface minimum.

Total loading shall not exceed 1500kg

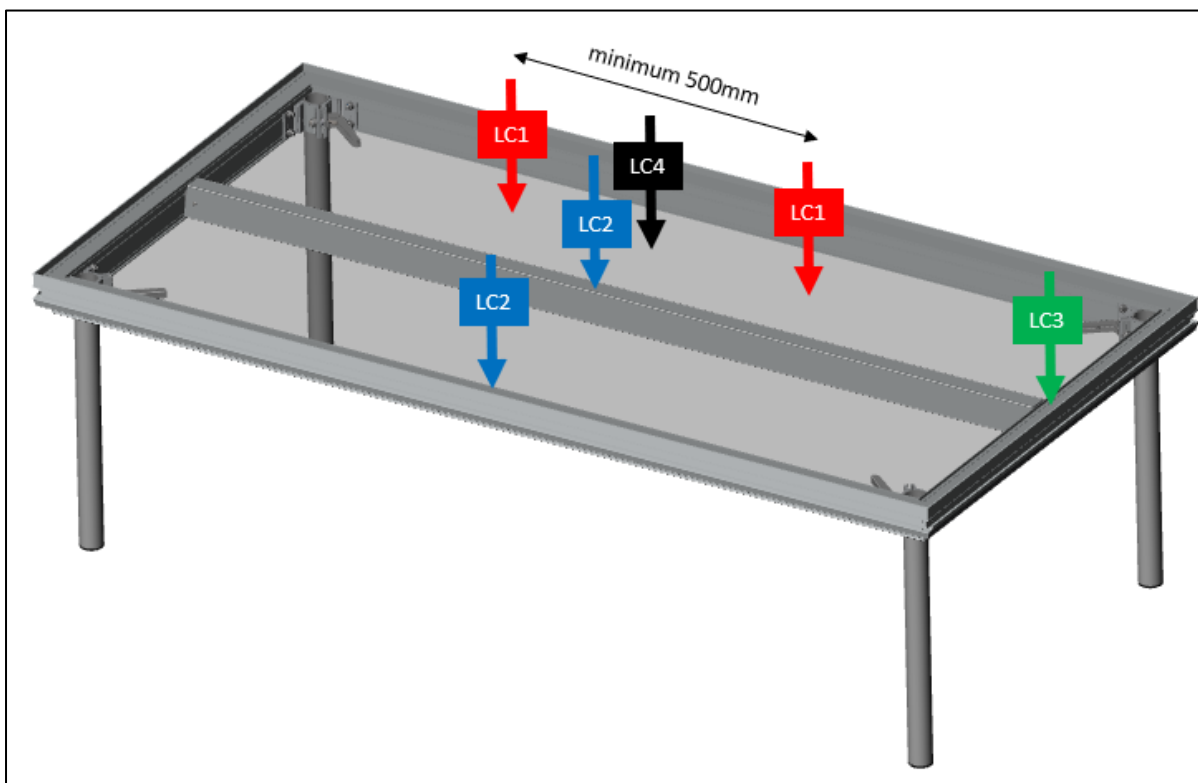

LOADING 4.3 MAXIMUM HORIZONTAL LOAD = 10% OF THE VERTICAL LOAD

OTHER LIMITATIONS 4.3

Staging Modules can be used in temperatures varying from -20°C up to +60°C.

The design of staging modules and tolerances of wood are based on an environmental humidity of 22 / 42% at a temperature between 18 and 26 degrees Celsius. Exceeding these numbers might cause damage and limitations of use. They may affect the warranty.

However, if Staging Modules are used below 0°C special attention must be taken. Capillary working of holes can cause water intrusion inside the profiles. If temperatures are below 0°C, captive water caused by intrusion or condensation will freeze and can cause damage.

Special attention must be taken when Staging Modules are used in aggressive environments or its near vicinity. The aluminium alloys used might not be particularly suitable for this environment.

Direct contact with concrete shall be avoided by means of a sealant. A special instruction form is available.

The alloy used has good properties in a salt water environment however, it can cause oxidation on the surface. Regular cleaning with fresh water or a dedicated protection is advised.

Despite the fact that water repellent glue is used to compose the plywood and that some staging modules are coated with paint or phenol layer topping, wood is a natural product and thus vulnerable for moisture. It will contract and expand.

 *It is strongly advised not to leave staging modules outside without proper protection against water intrusion*

 *The correct choice of required loading can vary per country. It is the responsibility of the user to comply to local legislation.*

5. TRANSPORT AND STORAGE see part 1

Transport all decking components flat on pallet, dolly or flight case. Make sure products are stored dry and in a dry, dust free and ventilated environment.

6. APPROVED ACCESSORIES

For a full list of approved accessories we refer to our website or latest product catalogue. Please see www.Sixty82.nl

7. COATINGS AND SURFACE TREATMENTS see part 1

8. ASSEMBLY & DISASSEMBLY INSTRUCTIONS

TOOLS NEEDED

- Allen key size 6 - for Art. 360004/stage-to-stage connector
- Allen key size 10 - for Art. 340014-17/ telescopic legs and adjustable stairs
- Wrench size 17 - for Art. 350005-10/railing - Art.351018/modular stair – Art.351015-16/Adjustable stair
- Leveler

GENERAL

Staging Modules shall be assembled by a competent person or sufficiently instructed personnel under supervision of a competent person. It is advised to physically show how to assemble and disassemble Staging Modules.

A competent person shall check prior to use if all Staging Modules are connected properly before applying loads.

ASSEMBLY INSTRUCTION

STEP 1 Place the type of legs chosen in the all leg pockets (item 1).

STEP 2 Tighten the legs by pulling the handle (item 2)

STEP 3 If the legs are still loose after tightening , remove the leg, Adjust the M10 nut (item 3)

STEP 4 Flip the deck over with 2 persons and put it in the required position

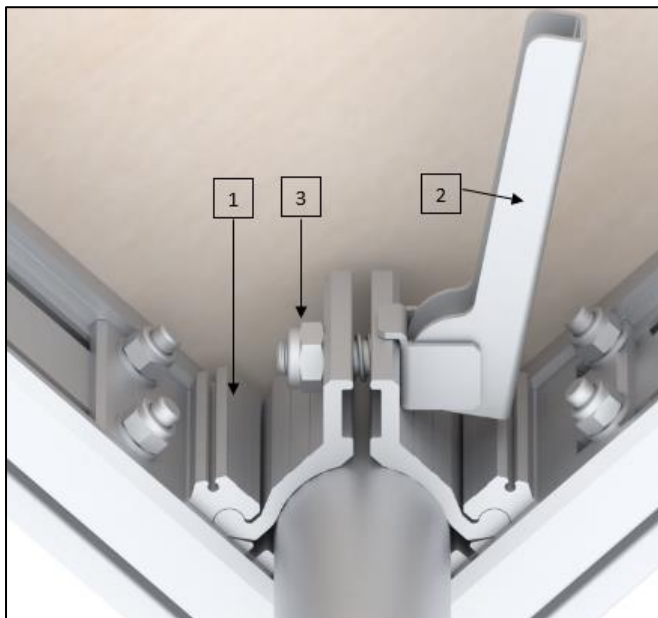

STEP 5 level the deck before attaching the next deck by means of a leveller. Use woodpads to underfill the legs if the legs have no means for levelling themselves.

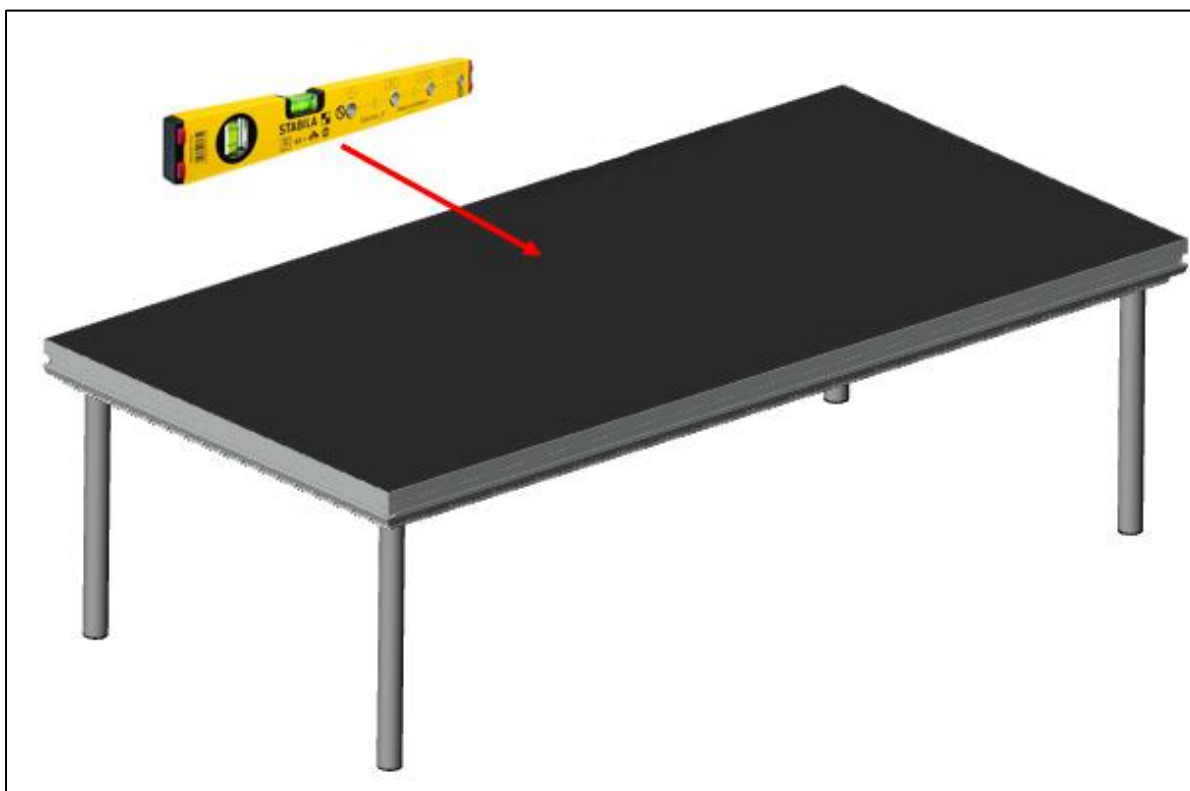

STEP 6 Interconnect each deck with 2 adjacent place decks by choosing one of the following options

6.1 In any case it is possible to use the **Stage-to-Stage leveller – Art. 360005**. This part equals differences in height and gives the decks more rigidity . When placed in the middle, it increase the point load at the particular point of use as two side beams work together.

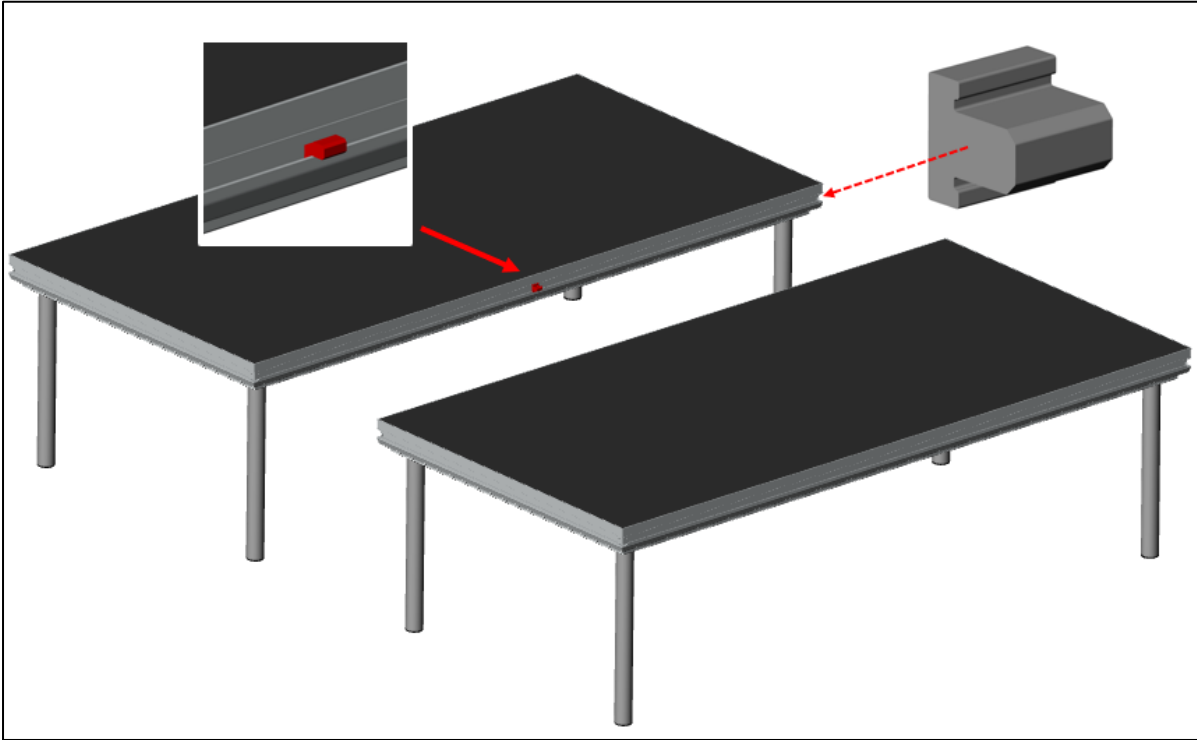

5.2 Use the Stage-to-Stage connector – Art. 360004

slide the connector in the groove on the side of each deck and hand tighten the Hexa-socket head bolt with an allen key

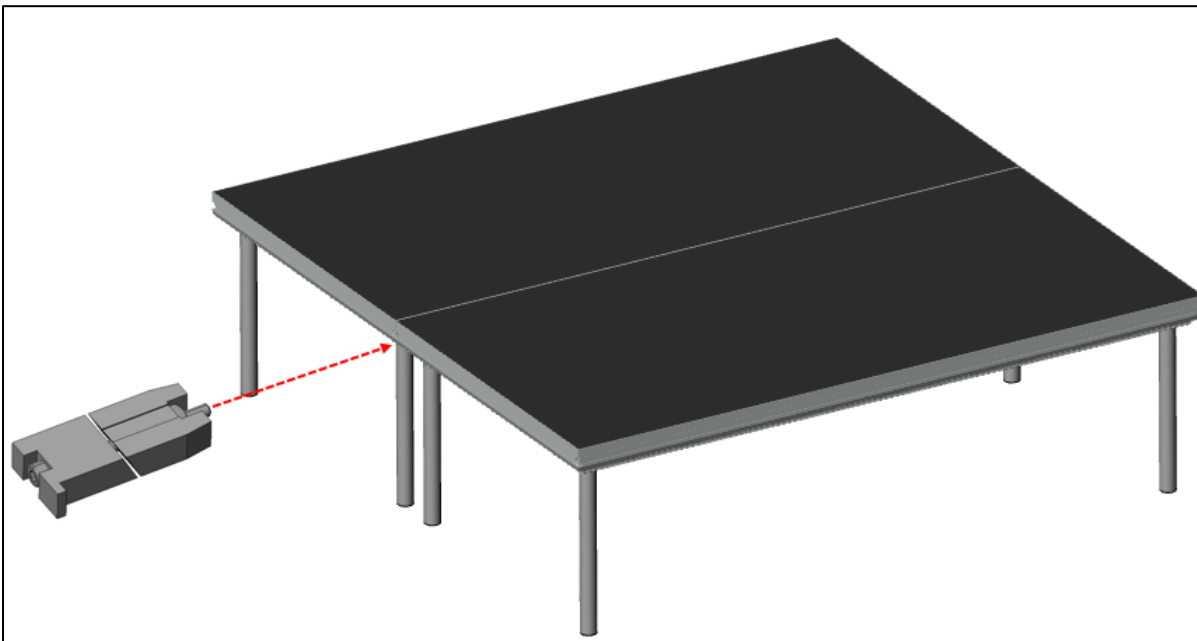

5.3 Use the Stage-to-Stage clamp - Art. 36004

Place the clamp at any desired position. When placed in the middle, it increases the point load at the particular point of use as two side beams work together. The clamp is designed in such way, it helps to level two adjacent decks. There is no need to use the Stage-to-Stage leveller.

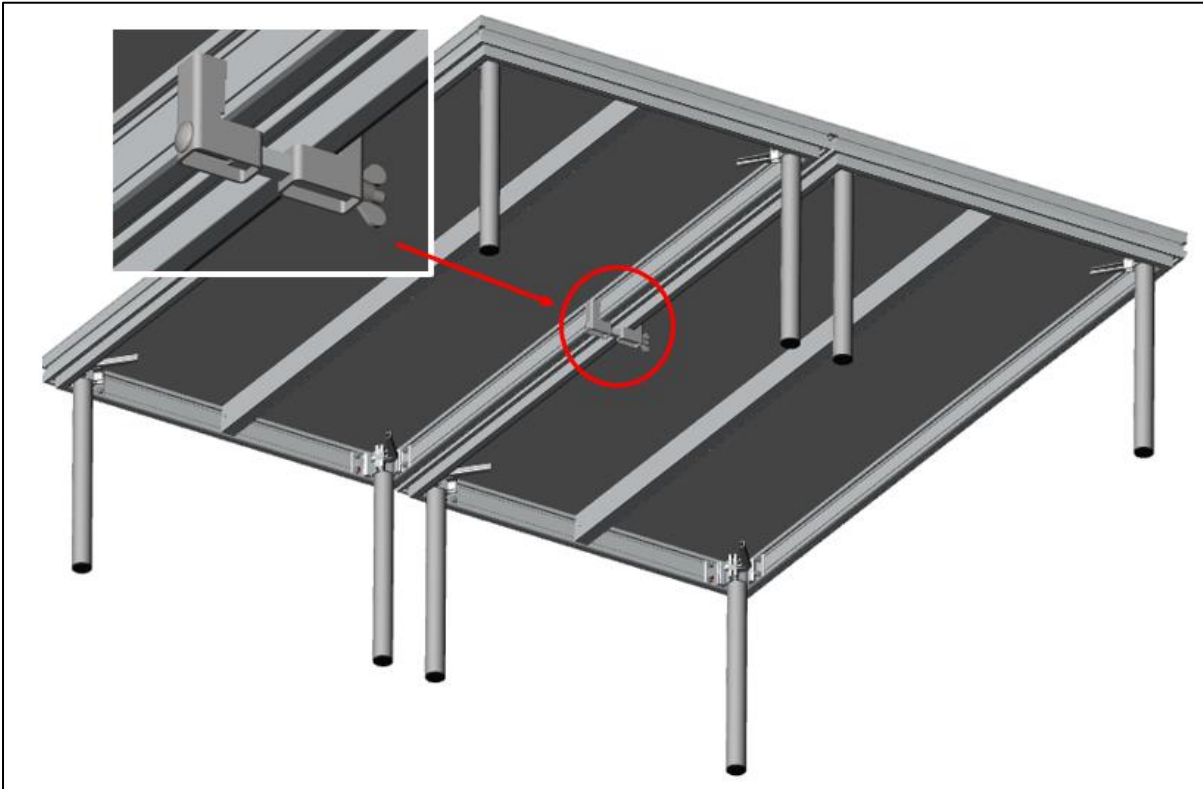

5.4 Use the Leg-to-Leg clamp - Art. 360035

When used to interconnect an assembled stage, follow the sequence below. This way a save, fast and easy accessible working method is created. The sequence shows the legs from above and the position of the leg-to-leg clamp

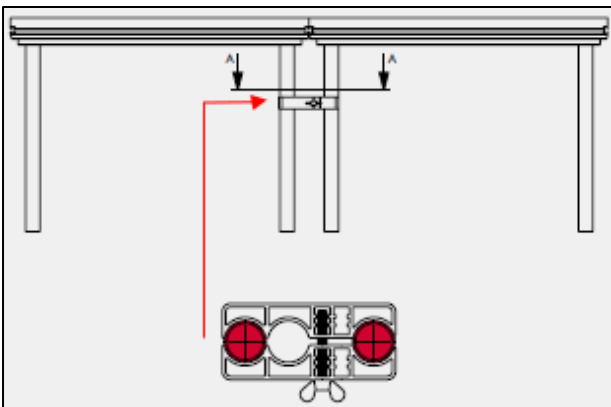

STEP 1

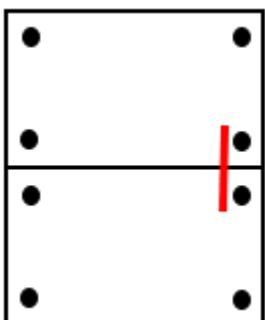

STEP 2

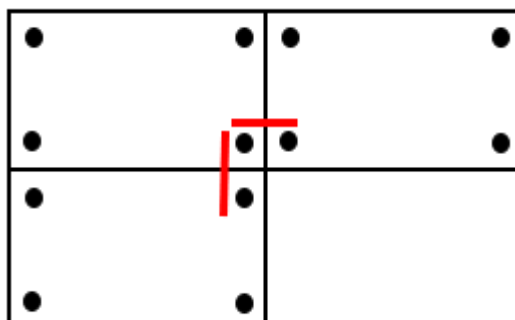

STEP 3

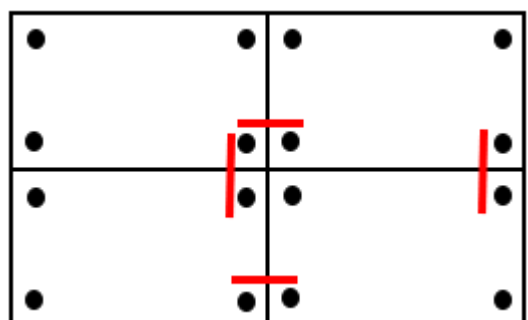

9. INSPECTIONS see part 1

10. MAINTENANCE AND DISCARD CRITERIA see part 1

11. LEGISLATION see part 1

DIN 15921 – Entertainment technology – aluminium platforms and frames- safety requirements and testing

12. GUARANTEE see part 1

13. DISCLAIMER Sixty82 has made every effort to ensure the accuracy of this manual, no liability will be accepted for errors. Sixty82 reserves the right to change or alter their products and documentation without prior notice. No part of this manual may be reproduced in any form or by any means without written permission. In case of a claim under the guarantee, a malfunction or spare part requirements please contact your point of sale or Sixty82.